









K Series 100 KG



WHEELS

		Diameter x tread (mm)	Hub x bore (mm)	Max load (kg)
	KJQ*	65 x 23	30 x 8	50
	TPE, precision ball bearing, thread guard	75 x 23	30 x 8	50
		100 x 23	30 x 8	50
	KNN	65 x 23	30 x 8	50
	Hard nylon, plain bearing, no thread guard	75 x 23	30 x 8	65
		100 x 23	30 x 8	70
	KSA	65 x 23	30 x 12	50
	Grey rubber, flat profile, plain bearing, optional thread guard ¹	75 x 23	30 x 12	50
		100 x 23	30 x 12	50
	KUQ*	75 x 23	30 x 8	100
	Polyurethane, precision bearing, optional thread guard ¹	100 x 23	30 x 8	100

FORKS

		Wheel Diameter	Height (mm)	Turning radius (mm)
	KZP	65	96	63
	Plate with swivel	75	104	69
		100	131	82
	KZPTB	65	96	89
	Plate with swivel and total brake	75	104	89
		100	131	89
	KZF	65	96	-
	Fixed plate, no swivel	75	104	-
		100	131	-
	KZH	65	96	63
	Bolt hole swivel	75	104	69
		100	131	82
	KZHTB	65	96	89
	Bolt hole swivel and total brake	75	104	89
		100	131	89

ORDER CODES

Wheel code	Fork code	Castor code ²
KJQ65G	K65ZP	KJQ65G/KZP
Diameter: 65 mm	K65ZPTB	KJQ65G/KZPTB
	K65ZF	KJQ65G/KZF
	K65ZH	KJQ65G/KZH
	K65ZHTB	KJQ65G/KZHTB
KJQ75G	K75ZP	KJQ75G/KZP
Diameter: 75 mm	K75ZPTB	KJQ75G/KZPTB
	K75ZF	KJQ75G/KZF
	K75ZH	KJQ75G/KZH
	K75ZHTB	KJQ75G/KZHTB
KJQ100G	K100ZP	KJQ100G/KZP
Diameter: 100 mm	K100ZPTB	KJQ100G/KZPTB
	K100ZF	KJQ100G/KZF
	K100ZH	KJQ100G/KZH
	K100ZHTB	KJQ100G/KZHTB
KNN65	K65ZP	KNN65/KZP
Diameter: 65 mm	K65ZPTB	KNN65/KZPTB
	K65ZF	KNN65/KZF
	K65ZH	KNN65/KZH
	K65ZHTB	KNN65/KZHTB
KNN75	K75ZP	KNN75/KZP
Diameter: 75 mm	K75ZPTB	KNN75/KZPTB
	K75ZF	KNN75/KZF
	K75ZH	KNN75/KZH
	K75ZHTB	KNN75/KZHTB

ORDER CODES

Wheel code	Fork code	Castor code ²
KNN100	K100ZP	KNN100/KZP
Diameter: 100 mm	K100ZPTB	KNN100/KZPTB
	K100ZF	KNN100/KZF
	K100ZH	KNN100/KZH
	K100ZHTB	KNN100/KZHTB
KSA65	K65ZP	KSA65/KZP
Diameter: 65 mm	K65ZPTB	KSA65/KZPTB
	K65ZF	KSA65/KZF
	K65ZH	KSA65/KZH
	K65ZHTB	KSA65/KZHTB
KSA75¹	K75ZP	KSA75/KZP
Diameter: 75 mm	K75ZPTB	KSA75/KZPTB
	K75ZF	KSA75/KZF
	K75ZH	KSA75/KZH
	K75ZHTB	KSA75/KZHTB
KSA100¹	K100ZP	KSA100/KZP
Diameter: 100 mm	K100ZPTB	KSA100/KZPTB
	K100ZF	KSA100/KZF
	K100ZH	KSA100/KZH
	K100ZHTB	KSA100/KZHTB
KUQ75¹	K75ZP	KUQ75/KZP
Diameter: 75 mm	K75ZPTB	KUQ75/KZPTB
	K75ZF	KUQ75/KZF
	K75ZH	KUQ75/KZH
	K75ZHTB	KUQ75/KZHTB
KUQ100¹	K100ZP	KUQ100/KZP
Diameter: 100 mm	K100ZPTB	KUQ100/KZPTB
	K100ZF	KUQ100/KZF
	K100ZH	KUQ100/KZH
	K100ZHTB	KUQ100/KZHTB

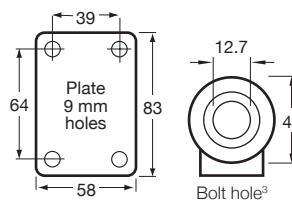

* Wheels also available with plain bearings—KJA, KUA.
Note that plain bearing bore is 12 mm.

¹ For optional thread guards, add **G** at the end of wheel code.

² For optional Chicago screw axles, add **C** at the end of castor code.

³ Bushes available to reduce bolt hole to 8 mm, 3/8" and 10 mm.

Grip-neck pintles also available (see page 59).