

Drum, Dead Man's and other Ergonomic Brake Casters

Medium Duty Industrial Top Plate Rigid Casters - Metric Standards

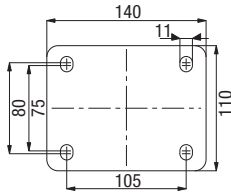

1,000 - 1,350 lbs



Rigid casters with drum brake:

Rigid casters with a drum brake can be operated by methods such as a cable pull or a lever arm. The enclosed design protects the brake shoes against corrosion and dirt. Therefore the brake performance is not affected by wet conditions or road contamination.

Rigid casters with dead man's brake:

Rigid casters with a dead man's brake are based on the drum brake caster design, however an integrated spring ensures the brake is applied in a non-operated condition. With a cable pull or lever arm the brake can be released.

Right version

Left version

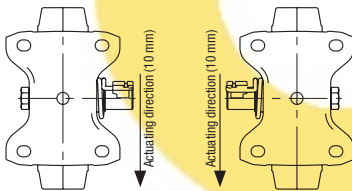

GEV-wheel series:

Tires: Made of high-quality elastic solid rubber in smooth rolling quality, 65° shore A, non-marking gray. Vulcanized tire.
Wheel center: Made of rugged gray cast iron, lacquered, silver, with two pressed-in ball bearings.

GST-wheel series:

Tread: Made of high-quality polyurethane-elastomer Blicke Softthane®, 75° shore A, green, non-marking, non-staining. Cast tread.
Wheel center: Made of rugged gray cast iron, lacquered, silver, with two pressed-in ball bearings.

GTH-wheel series:

Tread: Made of high-quality polyurethane-elastomer Blicke Extrathane®, 92° shore A, light brown, non-marking, non-staining. Cast tread.
Wheel center: Made of rugged gray cast iron, lacquered, silver, with two pressed-in ball bearings.

Rigid casters with drum brake	Rigid casters with dead man's brake *	Wheel Ø [inch] [mm]	Wheel width [inch] [mm]	Load capacity [lbs] [kg]	Bearing type	Total height [inch] [mm]	Plate size [mm]	Bolt hole spacing [mm]	For mounting bolt [inch]	G15 page
B-GEV series										
B-GEV 160K-TB-SG	B-GEV 160K-TM-SG	6 7/16 [160]	2 [50]	1000 [450]	Ball bearing	7 11/16 [196]	140 x 110	105 x 75-80	3/8	482
B-GEV 200K-TB-SG	B-GEV 200K-TM-SG	8 [200]	2 [50]	1350 [600]	Ball bearing	9 1/4 [235]	140 x 110	105 x 75-80	3/8	482
B-GST series										
B-GST 200K-TB	B-GST 200K-TM	8 [200]	2 [50]	1350 [600]	Ball bearing	9 1/4 [235]	140 x 110	105 x 75-80	3/8	482
B-GTH series										
B-GTH 160K-TB	B-GTH 160K-TM	6 7/16 [160]	2 [50]	1350 [600]	Ball bearing	7 11/16 [195]	140 x 110	105 x 75-80	3/8	482
B-GTH 200K-TB	B-GTH 200K-TM	8 [200]	2 [50]	1350 [600]	Ball bearing	9 1/4 [235]	140 x 110	105 x 75-80	3/8	482

* Product code has to be supplemented by the suffixes L for left and R for right version.

More options in the Blicke general catalog G15!

Options



	With pneumatic tires	With super-elastic solid rubber tires, puncture proof	Rigid brake caster, lever operated	Rigid brake caster operated by hidden switch cam **	With heavy duty rig	US-Standard top plate fitting 4 1/2" x 6 1/4"
Product code suffix	PS series	VLE series			BH series	BS series
Available for	upon request	upon request	upon request	upon request	upon request	upon request

** 7/16" or 13 mm

Dead Man's Brake Swivel Casters

Medium Duty Industrial Top Plate Swivel Casters - Metric Standards

1,350 lbs

✓RoHS

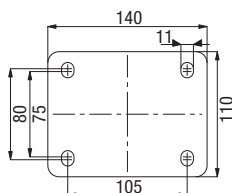

Swivel casters with dead man's wheel brake:

The dead man's brake is based on a drum brake, however an integrated spring ensures the brake is applied in a non-operated condition. Switch cam operated.



Swivel casters with dead man's wheel brake and swivel head brake:

The dead man's brake is based on a drum brake, however an integrated spring ensures the brake is applied in a non-operated condition. Switch cam operated.

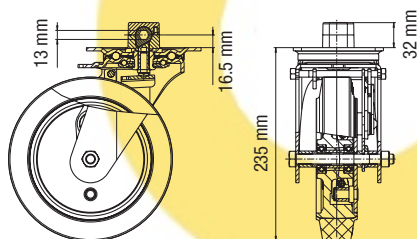

GEV-wheel series:

Tires: Made of high-quality elastic solid rubber in smooth rolling quality, 65° shore A, non-marking gray. Vulcanized tire.
Wheel center: Made of rugged gray cast iron, lacquered, silver, with two pressed-in ball bearings.



GST-wheel series:

Tread: Made of high-quality polyurethane-elastomer Blicke Softthane®, 75° shore A, green, non-marking, non-staining. Cast tread.
Wheel center: Made of rugged gray cast iron, lacquered, silver, with two pressed-in ball bearings.



GTH-wheel series:

Tread: Made of high-quality polyurethane-elastomer Blicke Extrathane®, 92° shore A, light brown, non-marking, non-staining. Cast tread.
Wheel center: Made of rugged gray cast iron, lacquered, silver, with two pressed-in ball bearings.

Swivel casters with dead man's brake	Swivel casters with dead man's brake and swivel head brake	Wheel Ø [inch] [mm]	Wheel width [inch] [mm]	Load capacity [lbs] [kg]	Bearing type	Total height [inch] [mm]	Plate size [mm]	Bolt hole spacing [mm]	For mounting bolt [inch]
L-GEV series									
L-GEV 200K-TM13-SG	L-GEV 200K-TTM13-SG	8 [200]	2 [50]	1350 [600]	Ball bearing	9 1/4 [235]	140 x 110	105 x 75-80	3/8"
L-GST series									
L-GST 200K-TM13	L-GST 200K-TTM13	8 [200]	2 [50]	1350 [600]	Ball bearing	9 1/4 [235]	140 x 110	105 x 75-80	3/8"
L-GTH series									
L-GTH 200K-TM13	L-GTH 200K-TTM13	8 [200]	2 [50]	1350 [600]	Ball bearing	9 1/4 [235]	140 x 110	105 x 75-80	3/8"

Options



	Swivel lock (retro fit) 1 x 360°	Dead man's wheel brake operated by threaded stem	Dead man's brake for hydraulic operating systems	Wheel Ø 6 5/16"	System operated with switch cam 7/16"
Product code suffix	RI-05.03				-TM7/16" / -TTM7/16"
Available for	upon request	upon request	upon request	upon request	upon request