

# Casters with Pneumatic and Soft Solid Tires

## Medium Duty Industrial Top Plate Casters - Metric Standards

165 - 1,000 lbs

✓RoHS

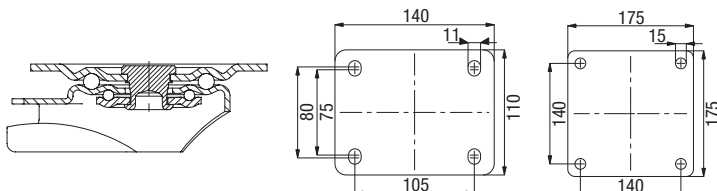

The L and B rig series with top plate fitting are available with the following wheels:

P



Tires: Pneumatic tires with ribbed or zig-zag profile, 2 or 4 ply rating, with tube, black.  
Rim: Pressed steel, with tubular steel hub, zinc-plated, blue-passivated, Cr6-free. Bearing type: Roller bearing.  
For more information refer to page 68

VLE



Tires: 2-component tires with hard rubber core and super-elastic, abrasion-resistant tread, steel-wire reinforced, black, **puncture proof**.  
Rims: Heavy pressed steel, bolted (flat based rim), with tubular steel hub, zinc-plated, blue-passivated, Cr6-free. Bearing type: Ball bearing.  
For more information refer to page 69



Profile R01

Profile B01

Profile B02



Profile R50

Profile B51

Swivel casters	Rigid casters	Swivel casters with 'stop-top' brake	Wheel Ø		Tire width		Load capacity		Bearing type	Total height		Plate size	Bolt hole spacing	For mounting bolt	Offset	Profile	G15 page
			[inch]	[mm]	[inch]	[mm]	[lbs]	[kg]		[inch]	[mm]						
L-P series																	
L-P 200R	B-P 200R	L-P 200R-ST	8	[200]	2	[50]	165	[75]	Roller bearing	9 ¼	[235]	140 x 110	105 x 75-80	¾	2 1½/32	R01	194
L-P 222R	B-P 222R	L-P 222R-ST	8 ¾	[220]	2 17/32	[65]	220	[100]	Roller bearing	10 1/64	[255]	140 x 110	105 x 75-80	¾	2 41/64	B01	194
L-P 263R	B-P 263R *	L-P 263R-ST	10 7/32	[260]	3 11½/32	[85]	330	[150]	Roller bearing	12 1/8	[308]	175 x 175	140 x 140	1/2	3 5/64	B02	194
				10 7/32	[260]	3 11½/32	[85]	330	[150]	Roller bearing	12 1/8	[308]	220 x 120	190 x 75	1/2		B02
L-P 267R	B-P 267R *	L-P 267R-ST	10 7/32	[260]	3 11½/32	[85]	550	[250]	Roller bearing	12 1/8	[308]	175 x 175	140 x 140	1/2	3 5/64	B02	194
				10 7/32	[260]	3 11½/32	[85]	550	[250]	Roller bearing	12 1/8	[308]	220 x 120	190 x 75	1/2		B02
L-VLE series (puncture proof)																	
L-VLE 250K	B-VLE 250K *	L-VLE 250K-ST	10	[250]	3 11½/32	[85]	1000	[450]	Ball bearing	11 39/64	[295]	175 x 175	140 x 140	1/2	2 ¾	R50	203
				10	[250]	3 11½/32	[85]	1000	[450]	Ball bearing	11 39/64	[295]	220 x 120	190 x 75	1/2		R50
L-VLE 255K	B-VLE 255K *	L-VLE 255K-ST	10	[250]	3 11½/32	[85]	1000	[450]	Ball bearing	11 39/64	[295]	175 x 175	140 x 140	1/2	2 ¾	B51	203
				10	[250]	3 11½/32	[85]	1000	[450]	Ball bearing	11 39/64	[295]	220 x 120	190 x 75	1/2		B51

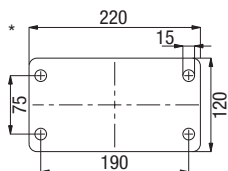

# CasterDepot

More options in the Blickle general catalog G15!

Options



	With non-marking gray rubber tire	With puncture-proof, foam-filled tire	Swivel lock (retro fit) 1 x 360° **	More heavy duty casters ***	With non-marking gray rubber tire	Antistatic version, black rubber tire	More heavy duty casters ****
Product code suffix	-SG	-AG	RI-05.03	P / PS series	-SN	-AS	LS-VLE series
Available for	P series upon request	P series upon request	P series, Ø 8" upon request	upon request	VLE series upon request	VLE series upon request	upon request

\*\* Only for swivel casters without brake

\*\*\* Up to a diameter of 21" and a load capacity of 2,860 lbs \*\*\*\* Up to a diameter of 20" and a load capacity of 4,150 lbs